

TAPMATE™ XL-424 MAIN DRILLING MACHINE



Transmate

a Division of Romac Industries, Inc.

MATERIAL SPECIFICATIONS

- 4" - 24" Taps.
- 300 PSI pressure rating.
- Can be used with existing TapMate and QuikValve equipment.
- Base Machine weighs 285 lbs.
- Taps any pipe commonly used in underground water mains.
- Storage crate functions as a workstation with storage space for tools, pilots and other accessories.
- Over 39 inches of travel.
- Integrated hydraulic motor.

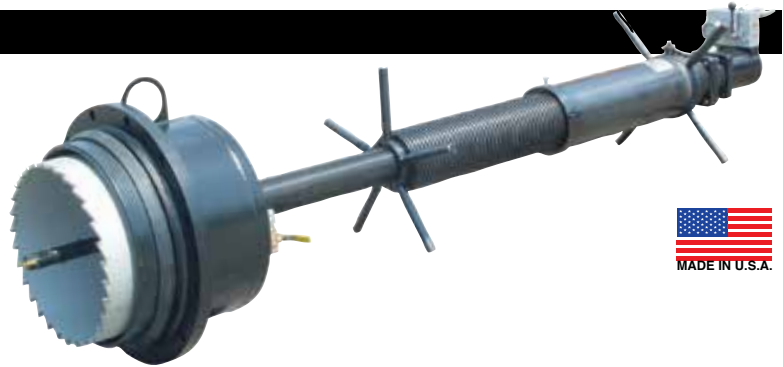

TO ORDER:

1. Order Base Machine
2. Order Adapters per size and outlet type
3. Order necessary Cutters.
4. Order extra Spade Bit if doing A/C taps
5. Select Power Unit.

ITEM NUMBER	DESCRIPTION	LIST PRICE
-------------	-------------	------------

366-00	TapMate XL-424 Drilling Machine	\$25,887.53
Approximate Shipping Weight (base machine and items included with base machine): 650 lbs.		

INCLUDED WITH BASE MACHINE:

366-42	Small Adapter Hub (4" - 12")	\$614.98
366-43	Large Adapter Hub (14" - 24")	705.61
366-38	TM-XL Shaft Nose, Complete (18" - 24")	770.35
366-38-2	TM-XL Shaft Nose, Complete (14"-16")	678.38
366-39	TM-XL PVC Pilot, Complete (18" - 24")	576.14
366-39-2	TM-XL PVC Pilot, Complete (14" - 16")	512.32
350-21-A	TM Shaft Nose, Complete (4" - 12")	385.72
350-04	TM PVC Pilot (4" - 12")	207.80
350-14	TM,Pilot Drill Extension <i>(required for 10" & 12" taps)</i>	\$153.84
366-66-10	Tool Kit & Spare Parts	556.72
366-61	Storage Crate / Work-station	1,275.28
372-02-05	1/2" Hose Kit <i>(includes two hoses and two sets of Quick Disconnects)</i>	835.91

82000 HPU HYDRAULIC POWER UNIT (ALSO ON PAGE TM-27)

- Weighs approximately 200 lbs.
- 14 h.p. Kohler gasoline engine.
- Hydraulic pump delivering 8 gpm to 2,000 psi.
- 5 gallon hydraulic fluid reservoir.
- 12V electric air-to-oil heat exchanger.

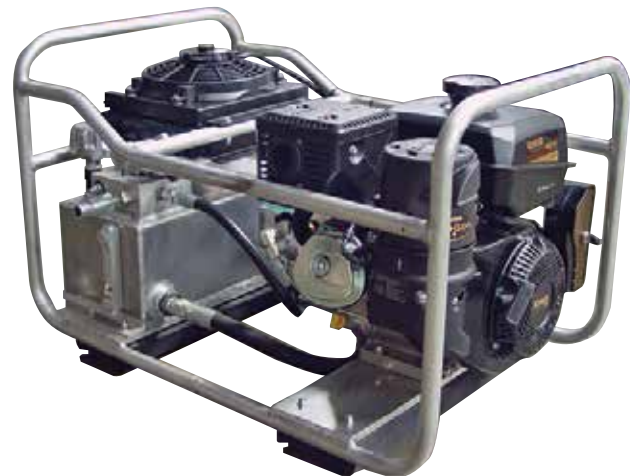

ITEM NUMBER	DESCRIPTION	LIST PRICE
*372-82000-01	82000 HPU Hydraulic Base Power Unit	\$7,979.71

*Considered Hazardous Material When Shipped by Air



Transmate

a Division of Romac Industries, Inc.

TAPMATE™ XL-424 ACCESSORIES

ITEM NUMBER	DESCRIPTION	LIST PRICE
ADAPTERS		
350-05-1032	4" MJ Adapter	\$579.94
350-05-1048	6" MJ Adapter	667.67
350-05-1064	8" MJ Adapter	786.36
350-05-1080	10" MJ Adapter	1,028.69
350-05-1096	12" MJ Adapter	1,157.79
366-05-1112	14" MJ Adapter	5,172.33
366-05-1128	16" MJ Adapter	6,078.62
366-05-1144	18" MJ Adapter	6,467.03
366-05-1160	20" MJ Adapter	6,855.44
366-05-1192	24" MJ Adapter	7,114.38
350-05-2032	4" Flange Adapter	\$579.94
350-05-2048	6" Flange Adapter	684.52
350-05-2064	8" Flange Adapter	786.99
350-05-2080	10" Flange Adapter	1,414.18
350-05-2096	12" Flange Adapter	1,542.94
366-05-2112	14" Flange Adapter	5,172.33
366-05-2128	16" Flange Adapter	6,078.62
366-05-2144	18" Flange Adapter	6,467.03
366-05-2160	20" Flange Adapter	6,855.44
366-05-2192	24" Flange Adapter	7,114.38

Special Adapter Bells (metric sizes and push-on style pipe connections) are also available.

ITEM NUMBER	DESCRIPTION	ACTUAL SIZE	LIST PRICE
CUTTERS			
For Ductile, Cast Iron, Steel & A/C			
350-01-1032	4" Carbide Cutter	3 1/2"	\$709.88
350-01-1048	6" Carbide Cutter	5 1/2"	1,052.20
350-01-1064	8" Carbide Cutter	7 1/2"	1,391.71
350-01-1080 ¹	10" Carbide Cutter	9 1/2"	3,107.61
350-01-1096 ¹	12" Carbide Cutter	11 1/2"	3,675.67
366-02-1108 ³	14" Carbide Cutter	13 1/2"	4,531.45
366-02-1124 ³	16" Carbide Cutter	15 1/2"	6,149.83
366-02-1140 ³	18" Carbide Cutter	17 1/2"	6,797.18
366-02-1156 ³	20" Carbide Cutter	19 1/2"	7,930.04
366-02-1180 ³	24" Carbide Cutter	22 1/2"	9,224.74
For HDPE & PVC			
350-01-2032 ²	4" Cutter for HDPE & PVC Pipe	3 1/2"	\$708.22
350-01-2048 ²	6" Cutter for HDPE & PVC Pipe	5 1/2"	1,049.64
350-01-2064 ²	8" Cutter for HDPE & PVC Pipe	7 1/2"	1,385.67
350-01-2080 ^{1,2}	10" Cutter for HDPE & PVC Pipe	9 1/2"	3,099.86
350-01-2096 ^{1,2}	12" Cutter for HDPE & PVC Pipe	11 1/2"	3,668.00
366-02-1108 ³	14" Carbide Cutter	13 1/2"	4,531.45
366-02-1124 ³	16" Carbide Cutter	15 1/2"	6,149.83
366-02-1140 ³	18" Carbide Cutter	17 1/2"	6,797.18
366-02-1156 ³	20" Carbide Cutter	19 1/2"	7,930.04
366-02-1180 ³	24" Carbide Cutter	22 1/2"	9,224.74
For Steel			
350-01-5032	4" Cutter for Steel	3 1/2"	\$709.88
350-01-5048	6" Cutter for Steel	5 1/2"	1,052.20
350-01-5064	8" Cutter for Steel	7 1/2"	1,391.71
350-01-5080 ¹	10" Cutter for Steel	9 1/2"	3,107.61
350-01-5096 ¹	12" Cutter for Steel	11 1/2"	3,677.31

- 1 10" and 12" Cutters require the Pilot Drill Extension
- 2 HDPE Pilot needed (350-04H) if tapping HDPE pipe only
- 3 Cutters are for use on Ductile, Cast Iron, Steel, A/C, PVC, and HDPE

ADAPTER PARTS

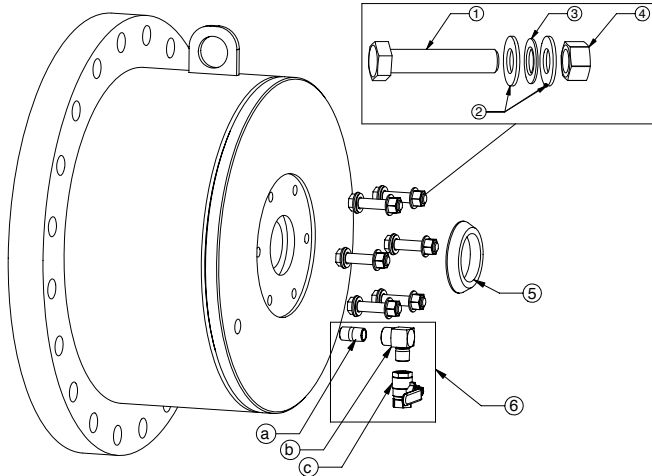

ACCESSORIES

350-03-08	1" Spade Bit	\$102.85
358-88	1 3/8" Spade Bit	202.70
350-04H	HDPE Pilot	390.57
350-52	Cutter Jam Nut	59.33
353-10-1	Tapping Compound	33.90
350-05-571	Adapter O-Ring	17.56
366-44	TM-XL Adapter Hub O-Ring	3.56
366-68	TM-XL Anti-Seize Lubricant	21.62

ITEM NUMBER	DESCRIPTION	LIST PRICE
1. 361-06-05	QV Flange Bolt (Qty. 6)	3.03 ea.
2. 8FW-410	Washer (Qty. 12)	1.36 ea.
3. 350-05-80.96-57	TM,Hub Adapter Seals (Qty. 6)	3.85 ea.
4. 350-05-80.96-52	TM,Hub Adapter Nuts (Qty. 6)	2.58 ea.
5. 8R211S0300	Gasket (Qty. 1)	4.74
6. 366-05-01	TM-XL, Adapter Exhaust Valve (Qty. 1)	49.85
6a. 356-01-03	BT Slide Gate Pipe Nipple (Qty. 1)	2.32
6b. 356-03-04	BT,Exhaust Elbow (Qty. 1)	18.29
6c. 371-02	AD Air Drive Valve (Qty. 1)	24.57

NEW 14" - 24" ROMAC CUTTERS

CAN BE ADAPTED TO FIT OTHER MANUFACTURER'S TAPPING MACHINES. CONTACT ROMAC FOR PRICING AND AVAILABILITY.

