

# SPRING WASHERS (CONTRACTION COMPENSATION FOR HDPE PIPE)

## SUBMITTAL INFORMATION

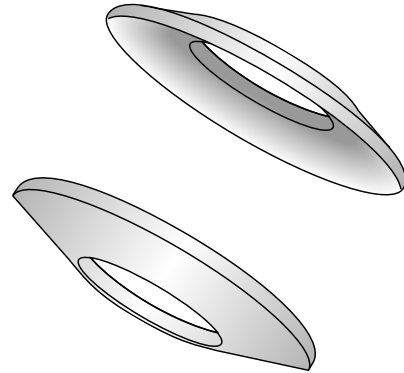

## APPLICATION

When installed properly, the spring washers will continue loading the bolts if the pipe contracts due to temperature or pressure loss.

## PRODUCTS

Stainless Steel Tapping Sleeve (SST-H)  
Fabricated Steel Tapping Sleeve (FTS 423-H)  
Stainless Steel Service Saddles (306-H & 305-H)  
Ductile Iron Services Saddles (101N-H & 202N-H)

Sewer Saddles (BP)  
Stainless Seal Repair Clamps (SS1-H, SS2-H & SS3-H)  
Stainless Seal Repair Clamps with tapped outlets (SS1-H, SS2-H & SS3-H with taps)

## MATERIALS

17-7 PH high strength stainless steel used for manufacturing springs.

## STRUCTURE

Washers are manufactured in a cup-like configuration, to be partially compressed while under the specified torque.

## SIZES

1/2 and 5/8 inch.

**NOTE:** The quantity of spring washers is based on temperature change of 53°F and pressure changes producing 0.5% contraction. Please contact Romac Engineering Department to determine number of washers if temperature, pressure or other conditions are different than specified. See HDPE section of catalog for further information.

## HDPE PRODUCT LIMITATIONS

- Pipe must be manufactured in accordance with AWWA Standard C906-90.
- Operating temperatures are limited to 85° F maximum and 32° F minimum.
- Operating pressure is limited to 150 psi or the rating of the pipe, whichever is less.
- Pipe systems must be designed to compensate for pipe movement so as to prevent fittings from migrating or rating on the pipe.
- Products are intended for use in underground service only.
- The SDR rating on which a Romac fitting can be used varies from product to product, check Romac catalog (HDPE section).

*This information is based on the best data available at the date printed above. Please check with Romac for any updates or changes.*