

HARNES LUG SCHEDULE							
FLANGE SIZE	LUG THK	TIE ROD QUANTITY		TIE ROD		RADIUS "B"	WGT, EA. (LBS)
		100 PSI	200 PSI	SIZE	A		
3	1	2	2	3/4	0.60	2.40	3.9
4	1	2	2	3/4	0.84	2.91	3.1
6	1	2	2	3/4	0.72	4.03	3.7
8	1	2	2	3/4	0.76	5.12	4.5
10	1	2	4	3/4	0.84	6.28	4.1
12	1	2	4	3/4	1.11	7.39	5.2
14	1	2	4	3/4	0.94	8.25	5.5
16	1	4	6	3/4	1.09	9.35	5.2
18	1	4	8	3/4	0.92	10.39	5.4
20	1.25	4	6	1	1.00	11.44	7.0
24	1.25	4	6	1	1.15	13.54	8.7
30	1.25	6	10	1	1.44	16.50	8.4
36	1.25	8	14	1	1.63	19.69	9.9

REVISIONS			
REV	DESCRIPTION	DATE	APPROVED
1	ADDED 100 PSI COLUMN IN TABLE, ADDED 18"	6/12/2007	NST III
2	ADDED LUG MATERIALS, ADDED WEIGHTS.	8/30/2007	NST III

NOTE:

- LUG DESIGN ALLOWS MAXIMUM CLEARANCE BETWEEN PIPE OR FLANGE HUB OD AND LUG.
- EACH TIE ROD REQUIRES 2 LUGS, ONE LOCATED ON THE OUTSIDE OF EACH FLANGED CONNECTION.
- LUG MATERIAL: STEEL A36, STAINLESS A240 TYPE 304 OR 316
- TIE ROD MATERIAL = ASTM A193 B7, (ALLOY STEEL), B8 (304 SS), OR B8M (316 SS)
- COATING: BARE, SHOPCOAT PAINT, OR NSF 61 FUSION BONDED EPOXY, BLACK
- 4 NUTS REQUIRED PER TIE ROD, (DOUBLE NUT CONFIGURATION.)
- HARNES LUG HAS STANDARD THICKNESS AND ROD SIZE FOR SIMPLICITY.
- TIE RODS SOLD SEPERATELY, SPECIFY LENGTH WHEN ORDERING.

BOLT CIRCLE, MATCHES AWWA C207 CLS D OR E AND ANSI B16.1 CLS 125 OR ANSI B16.5 CLS 150

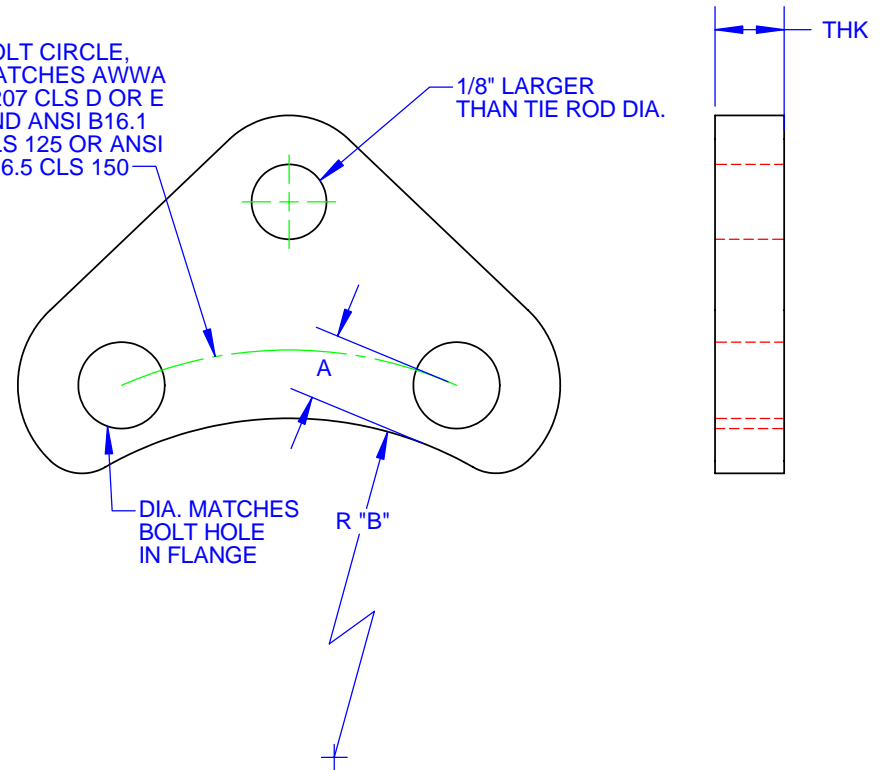

THIS DRAWING CONTAINS CONFIDENTIAL PROPRIETARY INFORMATION AND IS THE PROPERTY OF ROMAC IND., INC. IT'S TO BE USED ONLY FOR THE PURPOSE FOR WHICH IT'S SUBMITTED AND SHALL NOT HAVE ITS INFORMATION DISCLOSED OR REPRODUCED IN WHOLE OR IN PART FOR ANY PURPOSE WITHOUT PRIOR WRITTEN PERMISSION OF ROMAC IND., INC.

UNLESS OTHERWISE SPECIFIED DIMENSIONS ARE IN INCHES TOLERANCES ARE ON: 2 PL DECIMALS +/- .05 3 PL DECIMALS +/- ANGLES +/- FRACTIONS +/-	SIGNATURES N. THOGERSEN	DATE 10/04/2006		ROMAC IND. INC., SEATTLE, WA	
	CHECKED	TITLE HARNES LUG, 3" - 36", 3 HOLE ANSI CLS 125/150, 100 & 200 PSI, STYLE 494			
MATERIAL: SEE NOTE 3	SIZE A	DWG. NO. B2784-A	REV. NO. 2	SCALE NTS	
		SHEET 1 OF 1			