

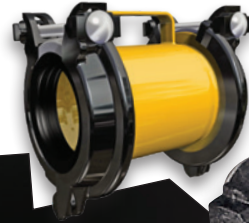

# MACRO HP™

ROMAC'S SECOND GENERATION TWO-BOLT  
EXTENDED RANGE COUPLING

**NEW  
SMALLER SIZES**



MACRO HP IS  
NOW AVAILABLE  
FOR 2 - 12 INCH  
PIPE SIZES



MACRO MACRO MACRO MACRO MACRO MACRO MACRO MACRO MACRO MACRO

PATENT NUMBERS:  
8448993, 9303801, 10253909

 **ROMAC**  
INDUSTRIES, INC.

1.800.426.9341 • WWW.ROMAC.COM

BMACROHP • 12.19.2019

1974



## THE ORIGINAL DUCTILE IRON TWO-BOLT COUPLING

IN 1974 ROMAC INTRODUCED OUR FIRST TWO-BOLT COUPLING, THE RINGWEJ™. THE PATENTED RINGWEJ™ WAS AVAILABLE IN TWO, FOUR, SIX AND EIGHT INCH SIZES.

1974 RINGWEJ™ BROCHURE. →



2009



## MACRO HP™

ROMAC'S SECOND GENERATION TWO-BOLT EXTENDED RANGE COUPLING

### • DESIGNED FOR STRENGTH AND LONG LIFE

- DUCTILE IRON END-RINGS AND CENTER-RING HAVE NO WELDS.
- HEAVY DUTY STAINLESS STEEL BOLTS WITH ANTI-GALLING PROTECTION.
- 304 STAINLESS STEEL ARMOR.
- CENTER RING IS FUSION BONDED EPOXY IN ACCORDANCE WITH AWWA C213 & NSF 61 CERTIFIED.
- END RINGS ARE E-COATED EPOXY.

### • EXTENDED RANGE GASKETS

- WITH A SINGLE ONE-PIECE GASKET, 4" - 12" MACRO COUPLINGS FITS IPS THROUGH CAST IRON PIPE DIAMETERS. XL SIZES COVER DI THROUGH OVERSIZE CAST IRON.
- FOR LARGER PIPE DIAMETERS A SEPARATE A/C GASKET IS INCLUDED.

### • EASY TO HANDLE AND INSTALL

- THE BUILT-IN HANDLE MAKES THE MACRO™ SIMPLE TO CARRY AND MANEUVER DURING INSTALLATION.
- STAB-FIT INSTALLATION.
- EACH END OF THE MACRO™ TIGHTENS INDEPENDENTLY WITH A SINGLE BOLT.
- IF YOUR WORK SPACE REQUIRES IT, THE END RINGS CAN BE CLOCKED.
- THE MACRO™ IS LIGHTER THAN TRADITIONAL COUPLINGS.

### • SEGMENTED END RINGS

- SEGMENTED END RINGS COMPRESS THE GASKETS EVENLY AROUND THE ENTIRE PIPE DIAMETER.
- THE END RING HINGES ALLOW THE MACRO™ TO BE EASILY DISASSEMBLED IF NECESSARY.

### • ALLOWS DEFLECTION

- THE MACRO™ CAN ACCOMMODATE PIPE DEFLECTION OF UP TO 10 DEGREES (5 DEGREES ON EACH END).

### • CATHODIC PROTECTION

- THE MACRO™ CAN BE ORDERED WITH AN ADAPTER FOR CATHODIC PROTECTION IF DESIRED.

### • ROMAC ORIGINAL DESIGN

- ROMAC MANUFACTURES THE MACRO™ IN THE U.S.A.
- PATENT NUMBERS: 8448993, 9303801, 10253909



Certified to NSF/ANSI 61 & 372



# MACRO HP DESIGN ADVANTAGES

## ALL DUCTILE IRON



RAW CENTER RING CASTING

DUCTILE IRON END-RINGS AND CENTER-RING OFFER EXCELLENT CORROSION RESISTANCE.

DUCTILE IRON PARTS HAVE DIFFERENT THICKNESSES ALONG THE CROSS-SECTION, ALLOWING THE PARTS TO CONCENTRATE STRENGTH WHERE IT NEEDS TO BE.



FULLY ASSEMBLED MACRO HP™ WITH EPOXY COATED CENTER-RING AND E-COATED EPOXY END-RINGS.

## SEGMENTED END RINGS



SEGMENTED END-RINGS

SEGMENTED END-RINGS APPLY COMPRESSION FORCES EVENLY AROUND THE GASKET TO PROVIDE A RELIABLE SEAL AROUND THE ENTIRE PIPE DIAMETER.

THE E-COATED EPOXY COATING ON THE END-RINGS IS HIGHLY RESISTANT TO ABRASION AND MAINTAINS CORROSION RESISTANCE AFTER INSTALLATION.



## MACRO HP HIGH PERFORMANCE ONE-PIECE GASKETS



OUT OF THE BOX, THE MACRO HP IS PRE-ASSEMBLED WITH A WIDE RANGE GASKET THAT COVERS MOST APPLICATIONS.



FOR INSTALLATIONS ON LARGER PIPE DIAMETERS, 4 - 12 INCH MACROS COME WITH A SEPARATE A/C GASKET

## EASY TO INSTALL



THE HANDLE IS BUILT INTO THE DUCTILE IRON CENTER RING

CARRYING AND POSITIONING THE MACRO™ IS EASY THANKS TO THE CENTER RING'S INTEGRATED HANDLE.

WITH ONLY TWO BOLTS ON THE TOP OF THE MACRO™, INSTALLATION IS A CINCH.



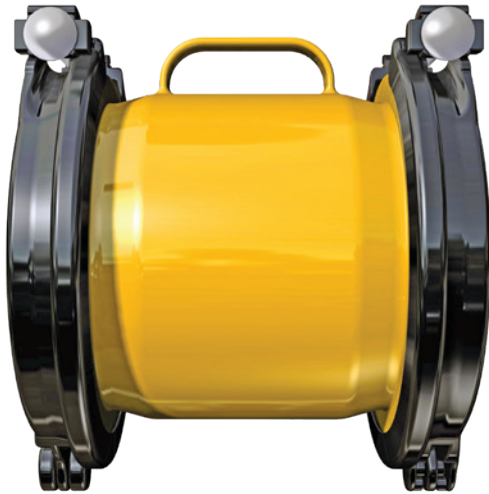

## CASTINGS

ALL CAST COMPONENTS (END RINGS, CENTER RING, AND BOLT GUIDES) ARE DUCTILE IRON, MEETING OR EXCEEDING THE REQUIREMENTS OF ASTM A 536, GRADE 65-45-12. END RINGS ARE SEGMENTED AND JOINED WITH HINGES. CENTER RING IS CAST WITH INTEGRATED HANDLE FOR EASE OF ASSEMBLY.

## GASKETS

MADE FROM VIRGIN ETHYLENE PROPYLENE DIENE MONOMER RUBBER (EPDM) COMPOUNDED FOR WATER AND SEWER SERVICE IN ACCORDANCE WITH ASTM D2000, NSF 61 CERTIFIED. NBR - NSF 61 GASKETS AVAILABLE UPON REQUEST.

## ARMORS

HEAVY GAUGE 304 STAINLESS STEEL BONDED TO GASKET.

## BOLTS & NUTS

304 STAINLESS STEEL (316 AVAILABLE UPON REQUEST).  
 4-12" SIZES:  $\frac{5}{8}$ " -11 UNC CARRIAGE HEAD BOLTS.  
 2 & 3" SIZES:  $\frac{1}{2}$ " -13 UNC CARRIAGE HEAD BOLTS.  
 HEAVY HEX NUTS. FASTENERS PROVIDED WITH ANTI-GALLING PROTECTION.

## COATINGS

CENTER RING IS FUSION BONDED EPOXY, NSF 61 CERTIFIED. CAN BE COATED TO AWWA C213 UPON REQUEST. END RINGS E-COATED EPOXY.

## PRESSURE RATING

THE MACRO CAN BE USED AT WORKING PRESSURES UP TO 305 PSI. CONTACT ROMAC ENGINEERING FOR DETAILS.

INFORMATION CONTAINED IN THIS DOCUMENT IS SUBJECT TO CHANGE. CONTACT ROMAC INDUSTRIES FOR ANY UPDATES.

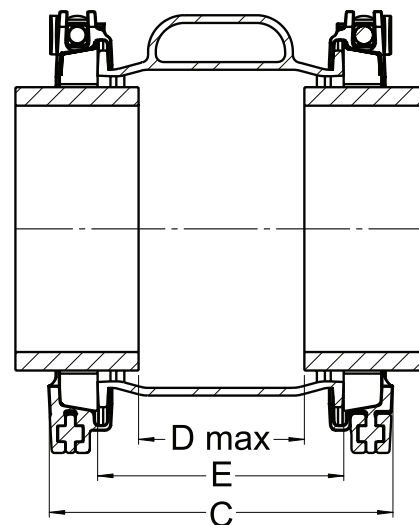
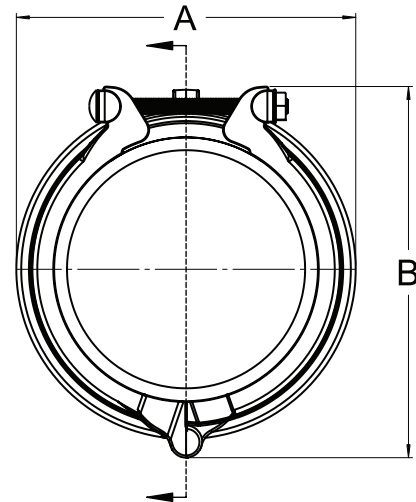

# MACRO HP ADD-ON OPTIONS



## MACRO LR (LOW-RANGE) GASKET

THE MACRO LR GASKET IS FOR SMALLER PIPE DIAMETERS SUCH AS OD STEEL. MAX. WORKING PRESSURE FOR MACRO HP WITH LR GASKET IS 200 PSI. LR GASKETS ARE NOT COMPATIBLE WITH 10" XL OR 12" XL SIZES. LR GASKETS ARE EPDM COMPOUNDED FOR WATER AND SEWER. NBR GASKETS AVAILABLE ON REQUEST.



PIPE SIZE	RANGE	CATALOG NUMBER	APPROXIMATE WEIGHT (LBS.)
4"	3.50 - 4.30	8R26104LR	0.68
6"	6.00 - 6.30	8R26106LR	0.96
8"	8.00 - 8.40	8R26108LR	1.25
10"	10.00 - 10.50	8R26110LR	1.67
12"	12.00 - 12.50	8R26112LR	1.80

TO ORDER LR GASKET: SPECIFY WHICH SIZED LR GASKET BY INDICATING THE CORRESPONDING CATALOG NUMBER [SHADED NUMBER IN LR GASKET ADD-ON TABLE].



## INSULATING BOOT COMPATIBLE WITH MACRO AND 501 COUPLINGS

ROMAC INSULATING BOOT EFFECTIVELY STOP ELECTROLYTIC ACTION BY ISOLATING ONE PIPE FROM THE OTHER. INSULATING BOOTS ARE ETHYLENE PROPYLENE DIENE MONOMER (EPDM) COMPOUNDED FOR WATER AND SEWER SERVICE.

NOMINAL PIPE SIZE	O.D. (INCHES)	LENGTH	APPROXIMATE WEIGHT (LBS.)
4"	4.50	6.00	0.75 #
	4.80	6.00	
6"	6.625	12.00	1.10 #
	6.90	12.00	
8"	8.625	12.00	1.20 #
	9.05	12.00	
10"	10.75	12.00	1.75 #
	11.10	12.00	
12"	12.75	12.00	2.10 #
	13.20	12.00	

IMPORTANT: INSULATING BOOTS ARE NOT DESIGNED FOR USE WITH 10" XL, 12" XL, OR MACRO LR GASKETS.

TO ORDER: SPECIFY PIPE OD.

## ADAPTED FOR CATHODIC PROTECTION



MECHANICAL CONNECTION FOR ADDING CATHODIC PROTECTION SUCH AS AN ANODE (ROMAC DOES NOT SUPPLY ANODE). LIST PRICE DOES NOT INCLUDE COUPLING.

TO ORDER "ADAPTED FOR CATHODIC PROTECTION" ADD-ON: ADD THE DESIGNATION "C" TO THE END OF THE COUPLING ORDER.

EXAMPLE: TO ORDER AN 8" MACRO ADAPTED FOR CATHODIC PROTECTION, ORDER: MACRO HP 9.75 - C.



# NEW

## MACRO HP SIZES 2 - 3 INCH



THE 2 AND 3 INCH MACRO HP COUPLINGS ARE DESIGNED TO FIT MOST COMMON PIPE MATERIALS.

FOR OTHER RANGES AND GASKET CONFIGURATIONS NOT SHOWN IN THE TABLE BELOW, CONTACT ROMAC INDUSTRIES, INC.

NOM. PIPE SIZE	COUPLING RANGE	DIMENSIONS (INCHES)					APPROX. WT. (LBS.)
		DIM. A WIDTH	DIM. B HEIGHT	DIM. C LENGTH	DIM. D GAP BETWEEN PIPE ENDS	DIM. E CENTER RING LENGTH	
2"	2.12 - 2.55	5.80	6.75	6.38	2.00	4.00	9
	2.50 - 2.90						
3"	3.13 - 3.63	7.20	8.36	8.38	4.00	6.00	12
	3.63 - 4.13						

## MACRO HP SIZES 4 - 12 INCH

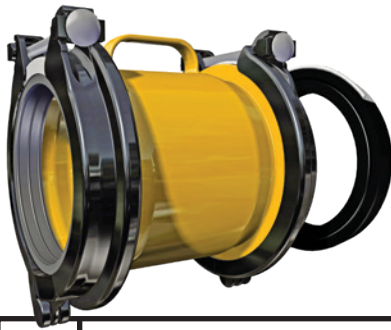

4 - 12 INCH MACRO COUPLINGS ARE PREASSEMBLED WITH STANDARD WIDE RANGE GASKETS THAT ACCOMMODATE IPS THROUGH CAST IRON PIPE. XL SIZES COVER DI THROUGH OVERSIZE CAST IRON PIPE DIAMETERS.

### A/C GASKET INCLUDED

FOR LARGER PIPE DIAMETERS SUCH AS SOME ASBESTOS CEMENT, A SEPARATE A/C GASKET IS INCLUDED.

NOM. PIPE SIZE	OVERALL COUPLING RANGE		DIMENSIONS (INCHES)					APPROX. WT. (LBS.)
	FACTORY PREASSEMBLED	INCLUDED, REQUIRES GASKET CHANGE	DIM. A WIDTH	DIM. B HEIGHT	DIM. C LENGTH	DIM. D GAP BETWEEN PIPE ENDS	DIM. E CENTER RING LENGTH	
4"	4.40 - 5.60		8.96	10.18	11.19	6.00	8.00	28
	FACTORY PREASSEMBLED WIDE RANGE GASKET 4.40 - 5.05	INCLUDED A/C GASKET 4.95 - 5.60						
6"	6.60 - 7.60		10.96	12.18	11.19	6.00	8.00	34
	FACTORY PREASSEMBLED WIDE RANGE GASKET 6.60 - 7.15	INCLUDED A/C GASKET 7.10 - 7.60						
8"	8.60 - 9.75		13.11	14.33	11.19	6.00	8.00	36
	FACTORY PREASSEMBLED WIDE RANGE GASKET 8.60 - 9.30	INCLUDED A/C GASKET 9.10 - 9.75						
10"	10.70 - 11.90		15.26	16.48	11.19	6.00	8.00	57
	FACTORY PREASSEMBLED WIDE RANGE GASKET 10.70 - 11.30	INCLUDED A/C GASKET 11.25 - 11.90						
10" XL	11.00 - 12.20		15.56	16.78	11.19	6.00	8.00	57
	FACTORY PREASSEMBLED WIDE RANGE GASKET 11.00 - 11.65	INCLUDED A/C GASKET 11.55 - 12.20						
12"	12.70 - 13.80		17.16	18.38	11.19	6.00	8.00	62
	FACTORY PREASSEMBLED WIDE RANGE GASKET 12.70 - 13.30	INCLUDED A/C GASKET 13.15 - 13.80						
12" XL	13.15 - 14.40		17.76	18.98	11.19	6.00	8.00	62
	FACTORY PREASSEMBLED WIDE RANGE GASKET 13.15 - 13.80	INCLUDED A/C GASKET 13.75 - 14.40						