



# MACRO HP™

ROMAC'S SECOND GENERATION TWO-BOLT  
EXTENDED RANGE COUPLING

MACROMACROMACROMA



Coupling Available  
in sizes 2"-16"



Flanged coupling  
Available in sizes  
4"-12"

patent numbers: 8448993, 9303801, 10253909

 **ROMAC**  
INDUSTRIES, INC.

1.800.426.9341 • [www.romac.com](http://www.romac.com)

BMACROHP • 10/13/21

1974



## THE ORIGINAL DUCTILE IRON TWO-BOLT COUPLING

In 1974 Romac introduced our first two-bolt coupling, the Ringwej™. The patented Ringwej™ was available in two, four, six and eight inch sizes.

1974 Ringwej™ brochure.



2009



## MACRO HP™

ROMAC'S SECOND GENERATION TWO-BOLT EXTENDED RANGE COUPLING

- DESIGNED FOR STRENGTH AND LONG LIFE
  - Ductile iron end-rings and center-ring have no welds.
  - Heavy duty stainless steel bolts with anti-galling protection.
  - 304 stainless steel armor.
  - Center ring is Romacote fusion bonded epoxy, NSF Certified. Center Ring can be coated to AWWA C213 upon request. End Rings are E-Coated epoxy.
  - End rings are e-coated epoxy.



2020



## Macro HP™ Flanged Coupling

- One bolt Macro HP™ end
- FIVE DEGREES OF DEFLECTION

## Macro HP™ line broadens to 16" size

- Accomodates 16 inch pipe sizes
- two bolts per end
- PROVIDES UP TO 8 DEGREES OF DEFLECTION
- Integrated carrying handles to easily maneuver

- EXTENDED RANGE GASKETS
  - With a single one-piece gasket, 2-16 inch Macro HP™ COUPLINGS FITS IPS THROUGH CAST iron pipe diameters. XL sizes cover DI through Oversize Cast Iron.
  - For larger pipe diameters a separate A/C gasket is included.
- EASY TO HANDLE AND INSTALL
  - The built-in handle makes the Macro HP™ simple to carry and maneuver during installation.
  - STAB-FIT INSTALLATION.
  - Each end of the Macro HP™ 2"-12" tightens independently with a single bolt, two bolts on 16".
  - The end rings can be clocked if your work space requires it.
  - The Macro HP™ is lighter than traditional couplings.
- SEGMENTED END RINGS
  - Segmented end rings compress the gaskets evenly around the entire pipe diameter.
  - The end ring hinges allow the Macro HP™ to be easily disassembled if necessary.
- ALLOWS DEFLECTION
  - The Macro HP™ can accommodate pipe DEFLECTION OF UP TO 10 DEGREES ON SIZES 2"-12" (5 degrees each end), and up to 8 degrees on 16" (4 degrees each end).
- CATHODIC PROTECTION
  - The Macro HP™ can be ordered with an adapter for cathodic protection if desired (4"-12" only).
- ROMAC ORIGINAL DESIGN
  - Manufactured in the U.S.A.
  - Patent Numbers: 8448993, 9303801, 10253909

# MACRO HP DESIGN ADVANTAGES

## ALL DUCTILE IRON



raw center ring casting

ductile iron end-rings and center-ring offer excellent corrosion resistance.

Ductile iron parts have different thicknesses along the cross-section, allowing the parts to concentrate strength where it needs to be.



fully assembled macro HP with epoxy coated center-ring and e-coated epoxy end-rings.

## SEGMENTED END RINGS



segmented end-rings

Segmented end-rings apply compression forces evenly around the gasket to provide a reliable seal around the entire pipe diameter.

The e-coated epoxy coating on the end-rings is highly resistant to abrasion and maintains corrosion resistance after installation.



## MACRO HP HIGH PERFORMANCE ONE-PIECE GASKETS



OUT OF THE BOX, THE MACRO HP IS PRE-ASSEMBLED WITH A WIDE RANGE GASKET THAT COVERS MOST APPLICATIONS.



FOR INSTALLATIONS ON LARGER PIPE DIAMETERS, 4-12 INCH MACROS COME WITH A SEPARATE A/C GASKET

## EASY TO INSTALL



the handle is built into the ductile iron center ring

Carrying and positioning the Macro HP™ is easy thanks to the center ring's integrated handle.

With minimal bolts on the Macro HP™, installation is a cinch.



# MACRO HP MATERIAL SPECIFICATIONS



## CASTINGS

All cast components (end rings, center ring, and bolt guides) are ductile iron, meeting or exceeding the requirements of ASTM A 536, grade 60-40-18. 4-12 inch end rings are segmented and joined with hinges, 16 inch end rings consist of 2 halves connected with bolts. Center ring is cast with integrated handle for ease of assembly.

## GASKETS

Made from virgin Ethylene Propylene Diene Monomer Rubber (EPDM) compounded for water and sewer service in accordance with ASTM D2000, NSF 61 CERTIFIED. NBR - NSF 61 GASKETS AVAILABLE UPON request, 2-12 inch.

## ARMORS

Heavy gauge 304 stainless steel bonded to gasket.

## BOLTS & NUTS

304 stainless steel (316 available upon request).  
4"-16" sizes:  $\frac{5}{8}$ " -11 UNC carriage head bolts.  
2" & 3" sizes:  $\frac{1}{2}$ " -13 UNC carriage head bolts.  
heavy hex nuts. Fasteners provided with anti-galling protection.

## COATINGS

Center ring is fusion bonded epoxy, NSF 61 CERTIFIED. CAN BE COATED TO AWWA C213 UPON request. End rings E-Coated epoxy.

## PRESSURE RATING

The MACRO HP™ can be used at working pressures up to 305 psi. Contact Romac Engineering for details.

Information contained in this document is subject to change. contact Romac Industries for any updates.

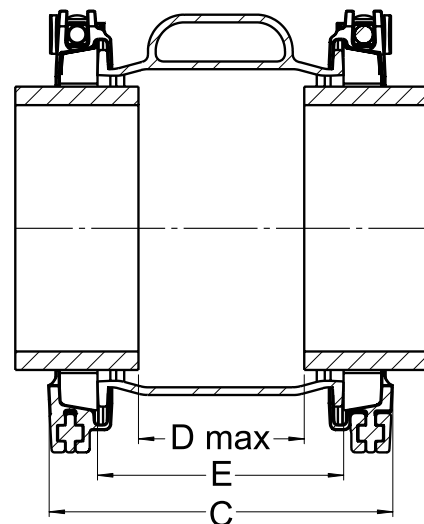
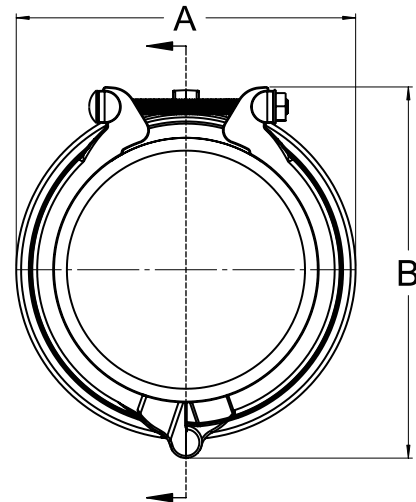

## MACRO HP SIZES 2 - 3 INCH



The 2 and 3 inch Macro HP Couplings are factory pre-assembled with gasket for lower range; inner gasket is easily removed to accommodate higher range.

FOR OTHER RANGES AND GASKET CONFIGURATIONS not shown in the table below, contact Romac Industries, Inc.



INNER RANGE  
FACTORY PRE-  
ASSEMBLED



OUTER RANGE  
REMOVE INNER  
GASKET

| NOM. PIPE SIZE | OVERALL COUPLING RANGE                     |   | DIMENSIONS [INCHES] |               |               |                              |                           | APPROX. WT. [LBS.] |
|----------------|--|---|---------------------|---------------|---------------|------------------------------|---------------------------|--------------------|
|                | INNER GASKET RANGE<br>FACTORY PREASSEMBLED | OUTER GASKET RANGE<br>REMOVE INNER GASKET | DIM. A width        | DIM. B height | DIM. C length | DIM. D gap between pipe ends | DIM. E center ring length |                    |
| 2"             | 2.12 - 2.55<br>inner gasket                | 2.12 - 2.90<br>outer gasket               | 5.80                | 6.75          | 6.38          | 2.38                         | 4.00                      | 9                  |
| 3"             | 3.13 - 3.63<br>inner gasket                | 3.13 - 4.13<br>outer gasket               | 7.20                | 8.36          | 8.38          | 4.38                         | 6.00                      | 12                 |

## MACRO HP SIZES 4 - 12 INCH



4 - 12 inch Macro Couplings are preassembled with standard wide range gaskets that accommodate IPS through cast iron pipe. XL sizes cover DI through Oversize Cast Iron pipe diameters.

### A/C GASKET INCLUDED

For larger pipe diameters such as some asbestos cement, a separate A/C gasket is included.

| NOM. PIPE SIZE | OVERALL COUPLING RANGE                                  |                                      | DIMENSIONS [INCHES] |               |               |                              |                           | APPROX. WT. [LBS.] |
|----------------|---|--------------------------------------|---------------------|---------------|---------------|------------------------------|---------------------------|--------------------|
|                | FACTORY PREASSEMBLED                                    | INCLUDED, REQUIRES GASKET CHANGE     | DIM. A width        | DIM. B height | DIM. C length | DIM. D gap between pipe ends | DIM. E center ring length |                    |
| 4"             | 4.40 - 5.05<br>factory preassembled wide range gasket   | 4.40 - 5.60<br>included A/C gasket   | 8.96                | 10.18         | 11.19         | 6.19                         | 8.00                      | 28                 |
| 6"             | 6.60 - 7.15<br>factory preassembled wide range gasket   | 6.60 - 7.60<br>included A/C gasket   | 10.96               | 12.18         | 11.19         | 6.19                         | 8.00                      | 34                 |
| 8"             | 8.60 - 9.30<br>factory preassembled wide range gasket   | 8.60 - 9.75<br>included A/C gasket   | 13.11               | 14.33         | 11.19         | 6.19                         | 8.00                      | 36                 |
| 10"            | 10.70 - 11.30<br>factory preassembled wide range gasket | 10.70 - 11.90<br>included A/C gasket | 15.26               | 16.48         | 11.19         | 6.19                         | 8.00                      | 57                 |
| 10" XL         | 11.00 - 11.65<br>factory preassembled wide range gasket | 11.00 - 12.20<br>included A/C gasket | 15.56               | 16.78         | 11.19         | 6.19                         | 8.00                      | 57                 |
| 12"            | 12.70 - 13.30<br>factory preassembled wide range gasket | 12.70 - 13.80<br>included A/C gasket | 17.16               | 18.38         | 11.19         | 6.19                         | 8.00                      | 62                 |
| 12" XL         | 13.15 - 13.80<br>factory preassembled wide range gasket | 13.15 - 14.40<br>included A/C gasket | 17.76               | 18.98         | 11.19         | 6.19                         | 8.00                      | 62                 |

## MACRO HP SIZE 16 INCH

16 inch Macro HP Couplings have only four bolts to tighten and are factory pre-assembled with gasket for lower range. The inner gasket is easily removed to accommodate higher RANGE. PROVIDES UP TO 8 DEGREES OF DEFLECTION (4 DEGREES each end).



| NOM. PIPE SIZE | OVERALL COUPLING RANGE                     |   | DIMENSIONS [INCHES] |               |               |                              |                           | APPROX. WT. [LBS.] |
|----------------|--|---|---------------------|---------------|---------------|------------------------------|---------------------------|--------------------|
|                | INNER GASKET RANGE<br>FACTORY PREASSEMBLED | OUTER GASKET RANGE<br>REMOVE INNER GASKET | DIM. A width        | DIM. B height | DIM. C length | DIM. D gap between pipe ends | DIM. E center ring length |                    |
| 16"            | 17.10 - 18.19<br>inner gasket              | 18.11 - 19.20<br>outer gasket             | 25.25               | 24.80         | 15.56         | 7.56                         | 12.00                     | 135                |

## MACRO HP FC SIZES 4 - 12 INCH

4 - 12 inch Macro Flanged Couplings are preassembled with a standard wide range gasket that accommodate IPS through cast iron pipe.

### A/C GASKET INCLUDED

For larger pipe diameters such as some asbestos cement, a separate A/C gasket is included.



| NOM. PIPE SIZE | OVERALL COUPLING RANGE                                  |                                      | DIMENSIONS [INCHES] |               |               |                     |                           | APPROX. WT. [LBS.] |
|----------------|---|--------------------------------------|---------------------|---------------|---------------|---------------------|---------------------------|--------------------|
|                | FACTORY PREASSEMBLED                                    | INCLUDED, REQUIRES GASKET CHANGE     | DIM. A width        | DIM. B height | DIM. C length | Min. pipe insertion | DIM. E center ring length |                    |
| 4"             | 4.40 - 5.05<br>factory preassembled wide range gasket   | 4.95 - 5.60<br>included A/C gasket   | 8.96                | 10.18         | 11.19         | 2.50                | 8.00                      | 28                 |
| 6"             | 6.60 - 7.15<br>factory preassembled wide range gasket   | 7.10 - 7.60<br>included A/C gasket   | 10.96               | 12.18         | 11.19         | 2.50                | 8.00                      | 36                 |
| 8"             | 8.60 - 9.30<br>factory preassembled wide range gasket   | 9.10 - 9.75<br>included A/C gasket   | 13.11               | 14.33         | 11.19         | 2.50                | 8.00                      | 49                 |
| 10"            | 10.70 - 11.30<br>factory preassembled wide range gasket | 11.25 - 11.90<br>included A/C gasket | 15.26               | 16.48         | 11.19         | 2.50                | 8.50                      | 67                 |
| 12"            | 12.70 - 13.30<br>factory preassembled wide range gasket | 13.15 - 13.80<br>included A/C gasket | 17.64               | 19.08         | 10.96         | 2.50                | 8.80                      | 81                 |

MACROMACROMACROMAC

## MACRO HP ADD-ON OPTIONS



### MACRO HP LR (Low-Range) GASKET

The MACRO LR gasket is for smaller pipe diameters such as OD Steel.

Max. working pressure for MACRO HP with LR gasket is 200 psi.

LR Gaskets are not compatible with 10

" XL or 12

" XL SIZES. LR Gaskets are

EPDM COMPOUNDED FOR WATER AND SEWER. NBR GASKETS AVAILABLE ON REQUEST.



| PIPE SIZE | RANGE         | CATALOG NUMBER | APPROXIMATE WEIGHT (LBS.) |
|-----------|---------------|----------------|---------------------------|
| 4"        | 3.50 - 4.30   | 8R26104LR      | 0.68                      |
| 6"        | 6.00 - 6.30   | 8R26106LR      | 0.96                      |
| 8"        | 8.00 - 8.40   | 8R26108LR      | 1.25                      |
| 10"       | 10.00 - 10.50 | 8R26110LR      | 1.67                      |
| 12"       | 12.00 - 12.50 | 8R26112LR      | 1.80                      |

To Order LR Gasket: Specify which sized LR gasket by indicating the corresponding Catalog Number [shaded number in LR gasket Add-On Table].



### INSULATING BOOT

Compatible with Macro HP and 501 Couplings

Romac's Insulating boot effectively stop electrolytic action by isolating one pipe from the other. Insulating boots are Ethylene Propylene Diene Monomer (EPDM) compounded for water and sewer service.

| NOMINAL PIPE SIZE | O.D. (inches) | Length | APPROXIMATE WEIGHT (LBS.) |
|-------------------|---------------|--------|---------------------------|
| 4"                | 4.50          | 6.00   | 0.75                      |
|                   | 4.80          | 6.00   |                           |
| 6"                | 6.625         | 12.00  | 1.10                      |
|                   | 6.90          | 12.00  |                           |
| 8"                | 8.625         | 12.00  | 1.20                      |
|                   | 9.05          | 12.00  |                           |
| 10"               | 10.75         | 12.00  | 1.75                      |
|                   | 11.10         | 12.00  |                           |
| 12"               | 12.75         | 12.00  | 2.10                      |
|                   | 13.20         | 12.00  |                           |

IMPORTANT: Insulating boots are not designed for use with 10" XL, 12" XL, or Macro LR Gaskets.

To Order: Specify pipe OD.



### ADAPTED FOR CATHODIC PROTECTION

Mechanical Connection for adding cathodic protection such as an anode (Romac does not supply anode). List price does not include coupling. Available in size 4" - 12".

To Order Adapted for Cathodic Protection Add-On: the designation "C" to the end of the coupling order.

Example: To order an 8" MACRO HP Adapted for Cathodic Protection, Order: MACRO HP 9.75 - C.



Add

# **ROMAC** INDUSTRIES, INC.

Repair Clamps • Couplings • Expansion Joints • Pipe Restraint • Service Saddles  
Tapping Sleeves • Tapping Machines • Valve Insertion • Waterworks Tools

1.800.426.9341 • [www.romac.com](http://www.romac.com)

