



MACRO HP

TWO-BOLT WIDE RANGE DUCTILE IRON COUPLING

TWO-BOLT WIDE RANGE DUCTILE IRON COUPLING

KEY COMPONENTS & ADVANTAGES

FEWER BOLTS

Each end tightens independently with anti-galling protected bolts made of heavy duty stainless steel.

TOP HANDLE

Carry your coupling to the installation site with one hand. Easily hold it in place and maneuver while installing.

SEGMENTED END RINGS

E-Coated epoxy end rings compress the gaskets evenly around the pipe diameter. Hinges allow the Macro HP to be easily disassembled if necessary.

ALL DUCTILE IRON

No-weld ductile iron end rings and body offer superior corrosion resistance.



ADDITIONAL ADVANTAGES

• EXTENDED RANGE GASKETS

2-16 inch Macro HP couplings are pre-assembled with nested gaskets that accommodate IPS through AC pipe. XL sizes cover DI through oversize cast iron pipe diameters.

• ALLOWS DEFLECTION

The Macro HP can accommodate pipe deflection of up to 10 degrees on sizes 2-12 inch (5 degrees on each end), and up to 8 degrees on 16 inch models (4 degrees on each end).

• CATHODIC PROTECTION

The Macro HP can be ordered with an adapted for cathodic protection if desired. (4-12 inch models only)

• ORIGINAL ROMAC DESIGN

The Macro HP is originally designed, manufactured, and tested in the USA. NSF 61/372 CERTIFIED.



MANUFACTURED IN THE U.S.A.
BY ROMAC INDUSTRIES, INC.
Patent Numbers: 8448993, 9303801 & 10253909

THE EVOLUTION OF THE MACRO HP



RINGWEJ

THE ORIGINAL DUCTILE IRON TWO-BOLT COUPLING

In 1974, Romac introduced our first two-bolt coupling, the Ringwej™.

The patented Ringwej™ was available in two, four, six, and eight inch sizes.

This product was the first of its kind, sparking many competing manufacturers to produce similar products.

MACRO HP



SECOND GEN TWO-BOLT EXTENDED RANGE COUPLING

Designed for strength and long life, the Macro HP end rings and center ring are made from ductile iron and have no welds. Equipped with heavy duty stainless steel bolts with anti-galling protection and 304 stainless steel armor. End rings are e-coated epoxy. Center ring is Romacote fusion bonded epoxy, NSF61/372 certified. Can be coated to AWWA C213 upon request.

MACRO HP FLANGED COUPLING



SECOND GEN MACRO-END FLANGED COUPLING

New design adds more flexibility to the Macro HP range allowing for five degrees of deflection with a one-bolt Macro HP end. Macro HP range also broadens to 16" size to accommodate 16-inch pipe sizes, providing up to 8 degrees of deflection.

MACRO HP MATERIAL SPECIFICATIONS



CASTINGS:

All cast components (end ring, center ring and bolt guides) are ductile iron, meeting or exceeding the requirements of ASTM A 536, grade 65-45-12 or 60-40-18. 4"-12" end rings are segmented and joined with hinges. 16" end rings consist of 2 halves connected with bolts. Center ring is cast with integrated handle for ease of assembly.

GASKETS:

Made from virgin ethylene propylene diene monomer rubber (EPDM) compounded for water and sewer service in accordance with ASTM D2000, NSF 61 certified. NBR - NSF 61 gaskets available upon request, 2"-12".

ARMORS:

Heavy gauge 304 stainless steel bonded to gasket.

BOLTS & NUTS:

304 stainless steel (316 available upon request).
4"-16" sizes: 5/8" - 11 UNC Carriage head bolts.
2" & 3" sizes: 1/2" - 13 UNC Carriage head bolts.
Heavy hex nuts. Fasteners provided with anti-galling protection.

COATINGS:

Center ring is fusion bonded epoxy, NSF 61 certified. Can be coated to AWWA C213 upon request. End rings are e-coated epoxy.

PRESSURE RATING:

The Macro HP™ can be used at working pressures up to up to 305 PSI. Contact us for details.

NSF 61/372 CERTIFIED.

*Information contained in this document is subject to change.
Contact us to ask about updates.*

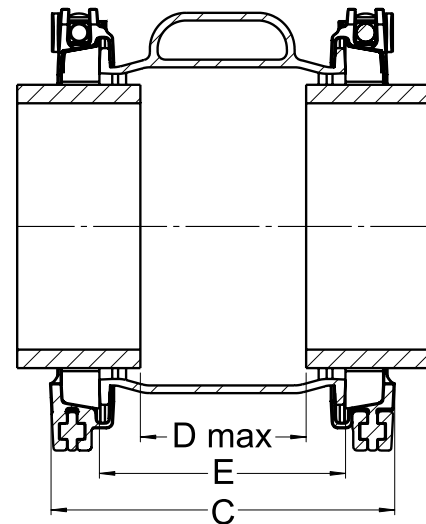
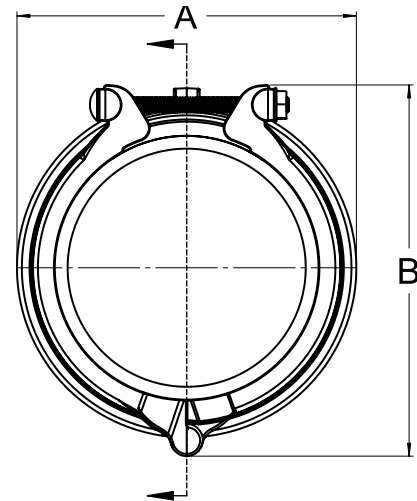

MACRO HP SIZES 2-3 INCH

The 2 and 3 inch Macro HP couplings are pre-assembled with gasket in our factory for lower range; inner gasket is easily removed to accommodate higher range.

For other ranges and gasket configurations not shown in the table below, contact us using the information in the footer of this page.



INNER GASKET RANGE
FACTORY PRE-ASSEMBLED

OUTER GASKET RANGE
REMOVE INNER GASKET

NOM. PIPE SIZE	OVERALL COUPLING RANGE			DIMENSIONS (INCHES)					
	INNER GASKET RANGE FACTORY PRE-ASSEMBLED	OUTER GASKET RANGE REMOVE INNER GASKET		A: WIDTH	B: HEIGHT	C: LENGTH	D: GAP BETWEEN PIPE ENDS	E: CENTER RING LENGTH	APPROX WGT (lbs.)
2"	INNER GASKET 2.12 - 2.55	2.12 - 2.90	OUTER GASKET 2.50 - 2.90	5.80	6.75	6.38	2.38	4.00	9
3"	INNER GASKET 3.13 - 3.63	3.13 - 4.13	OUTER GASKET 3.63 - 4.13	7.20	8.36	8.38	4.38	6.00	12

MACRO HP SIZES 4-12 INCH

4 through 12 inch Macro HP couplings are pre-assembled with nested gaskets that accommodate IPS through AC pipe.

XL sizes cover DI through oversize cast iron pipe diameters.

NOM. PIPE SIZE	OVERALL COUPLING RANGE			DIMENSIONS (INCHES)					
	INNER GASKET RANGE FACTORY PRE-ASSEMBLED	OUTER GASKET RANGE REMOVE INNER GASKET		A: WIDTH	B: HEIGHT	C: LENGTH	D: GAP BETWEEN PIPE ENDS	E: CENTER RING LENGTH	APPROX WGT (lbs.)
4"	INNER GASKET 4.40 - 5.05	4.40 - 5.60	OUTER GASKET 4.95 - 5.60	8.96	10.18	11.19	6.19	8.00	28
6"	INNER GASKET 6.60 - 7.15	6.60 - 7.60	OUTER GASKET 7.10 - 7.60	10.96	12.18	11.19	6.19	8.00	34
8"	INNER GASKET 8.60 - 9.20	8.60 - 9.75	OUTER GASKET 9.10 - 9.75	13.11	14.33	11.19	6.19	8.00	36
10"	INNER GASKET 10.70 - 11.30	10.70 - 11.90	OUTER GASKET 11.25 - 11.90	15.26	16.48	11.19	6.19	8.00	57
10XL	INNER GASKET 11.00 - 11.65	11.00 - 12.20	OUTER GASKET 11.55 - 12.20	15.56	16.78	11.19	6.19	8.00	57
12"	INNER GASKET 12.70 - 13.30	12.70 - 13.80	OUTER GASKET 13.15 - 13.80	17.16	18.38	11.19	6.19	8.00	62
12XL	INNER GASKET 13.15 - 13.80	13.15 - 14.40	OUTER GASKET 13.75 - 14.40	17.76	18.98	11.19	6.19	8.00	62

MACRO HP 16 INCH

16 inch Macro HP couplings have only four bolts to tighten and are factory pre-assembled with gasket for lower range. The inner gasket is easily removed to accommodate higher range. Provides up to 4 degrees of deflection per end, 8 degrees total.



NOM. PIPE SIZE	OVERALL COUPLING RANGE			DIMENSIONS (INCHES)					
	INNER GASKET RANGE <small>FACTORY PRE-ASSEMBLED</small>	OUTER GASKET RANGE <small>REMOVE INNER GASKET</small>		A: WIDTH	B: HEIGHT	C: LENGTH	D: GAP BETWEEN PIPE ENDS	E: CENTER RING LENGTH	APPROX WGT (lbs.)
16"	INNER GASKET 17.10 - 18.19	17.10 - 19.20	OUTER GASKET 18.11 - 19.20	25.25	24.80	15.56	7.56	12.00	135

MACRO HP FC SIZES 4-12 INCH

4 through 12 inch Macro HP flanged couplings are pre-assembled with a nested gasket that accommodates IPS through A/C pipe.



NOM. PIPE SIZE	OVERALL COUPLING RANGE			DIMENSIONS (INCHES)					
	INNER GASKET RANGE <small>FACTORY PRE-ASSEMBLED</small>	OUTER GASKET RANGE <small>REMOVE INNER GASKET</small>		A: WIDTH	B: HEIGHT	C: LENGTH	D: MINIMUM PIPE INSERTION	E: CENTER RING LENGTH	APPROX WGT (lbs.)
4"	INNER GASKET 4.40 - 5.05	4.40 - 5.60	OUTER GASKET 4.95 - 5.60	8.96	10.18	11.19	2.50	8.00	28
6"	INNER GASKET 6.60 - 7.15	6.60 - 7.60	OUTER GASKET 7.10 - 7.60	10.96	12.18	11.19	2.50	8.00	36
8"	INNER GASKET 8.60 - 9.20	8.60 - 9.75	OUTER GASKET 9.10 - 9.75	13.11	14.33	11.19	2.50	8.00	49
10"	INNER GASKET 10.70 - 11.30	10.70 - 11.90	OUTER GASKET 11.25 - 11.90	15.26	16.48	11.19	2.50	8.50	67
12"	INNER GASKET 12.70 - 13.30	12.70 - 13.80	OUTER GASKET 13.15 - 13.80	17.64	19.08	10.96	2.50	8.80	81

MACRO HP LR (LOW RANGE) GASKET

The Macro LR gasket is for smaller pipe diameters such as OD steel. Maximum working pressure for Macro HP with LR gasket is 200 PSI. LR gaskets are not compatible with 10XL or 12XL sizes. LR gaskets are EPDM compounded for water and sewer. NBR gaskets available upon request.



PIPE SIZE	RANGE	CATALOG NUMBER	APPROX. WGT. (LBS)
4"	3.50 - 4.30	8R26104LR	0.68
6"	6.00 - 6.30	8R26106LR	0.96
8"	8.00 - 8.40	8R26108LR	1.25
10"	10.00 - 10.50	8R26110LR	1.67
12"	12.00 - 12.50	8R26112LR	1.80

To order LR gasket: specify which size LR gasket by indicating the corresponding catalog number (shaded number in LR gasket table).

INSULATING BOOT

Romac's insulating boot effectively stops electrolytic action by isolating one pipe from the other. Insulating boots are ethylene propylene diene monomer (EPDM) compounded for water and sewer service. Compatible with Macro HP and 501 couplings.

Important: Insulating boots are not designed for use with 10XL, 12XL, or Macro LR gaskets.

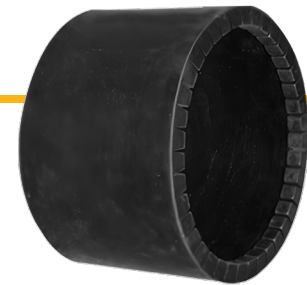

NOM. PIPE SIZE	O.D. (INCHES)	LENGTH (INCHES)	APPROX. WGT. (LBS)
4"	4.50	6.00	0.75
	4.80		
6"	6.625	12.00	1.10
	6.90		
8"	8.625	12.00	1.20
	9.05		
10"	10.75	12.00	1.75
	11.10		
12"	12.75	12.00	2.10
	13.20		

ADAPTED FOR CATHODIC PROTECTION



Mechanical connection for adding cathodic protection such as an anode (Romac does not supply anode). List price does not include coupling. Available in size 4"-12".

To order adapted for cathodic protection add-on: Add designation "C" to the end of the coupling order.

Example: to order an 8" Macro HP adapted for cathodic protection, order: Macro HP 9.75 - C



**Repair Clamps • Couplings • Expansion Joints • Pipe Restraint • Service Saddles
Tapping Sleeves • Tapping Machines • Valve Insertion • Waterworks Tools**

1.800.426.9341 • www.romac.com