

Transmate

TapMate Too Hydraulic Power Drive 372-351-05

Thank you for your purchase of the TapMate Too Hydraulic Power Unit. This power unit should give you years of performance if just a few rules are followed. Read all accompanying manuals and literature before using this power unit. The power unit is sent without any fluids in it, so make sure to fill all fluid reservoirs to the recommended levels.

If you have any questions, please call us at 1-800-426-9341

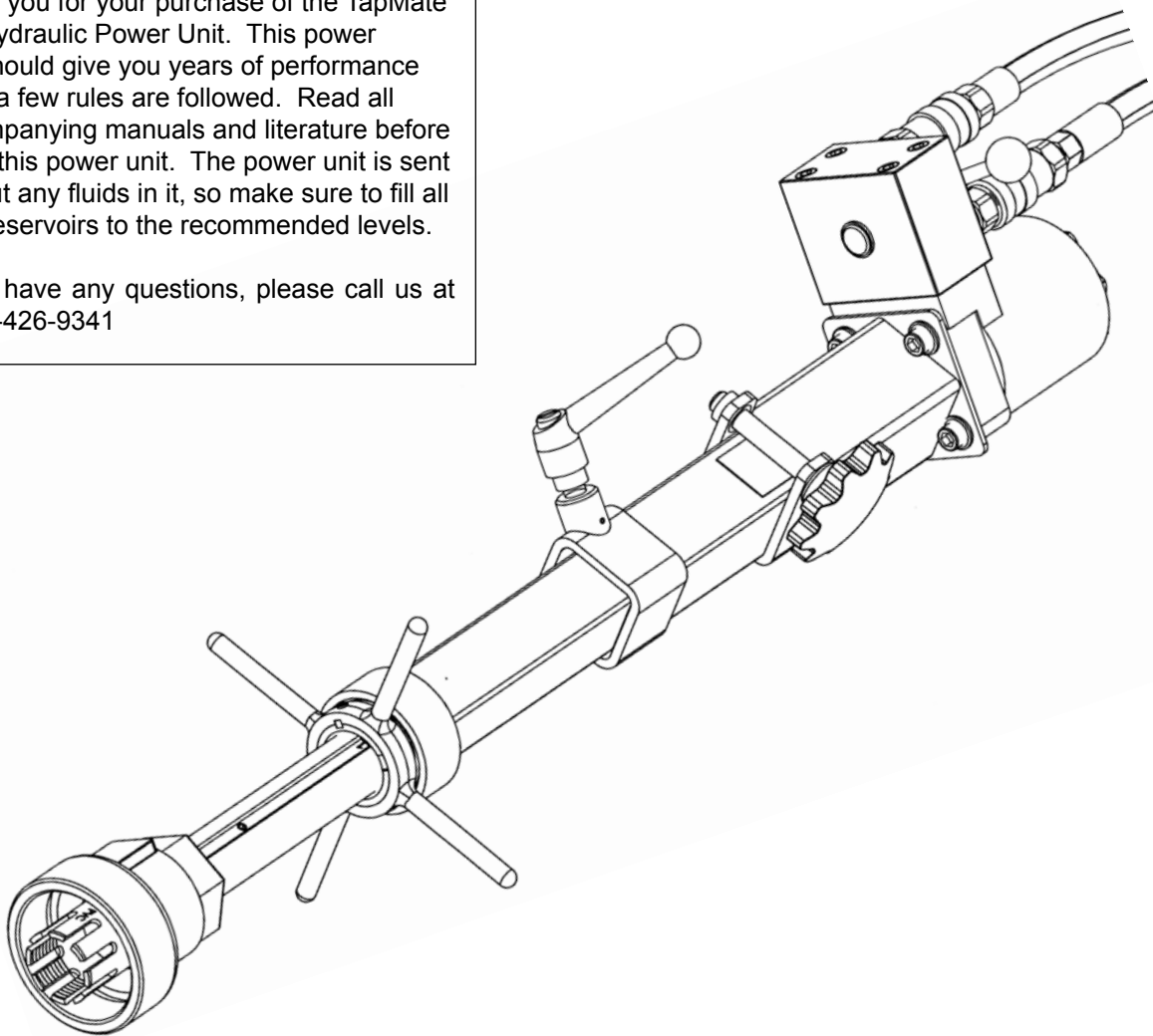

If you already own a TapMate Too and have purchased this power drive, read the section on “Fitting the Power Drive to your current TapMate Too”. You may have to modify your machine to fit your new power drive.

Inspection and Start up:

1. Check oil level and fill to the recommended level as stated in the engine manual. Oil is a major factor affecting performance and service life. SAE 10W-30, API SJ, for general use, see engine manual for specific information.
2. Check and fill gasoline tank as prescribed in the engine manual (Unleaded gasoline with a pump octane rating of 86 or higher).
3. Check hydraulic fluid level and fill to one inch from the top of the reservoir.

Depending on outside temperature:

- 0 - 100 Deg. F use oil with ISO number 32
32 - 120 Deg. F use oil with ISO number 46

If used in extreme temperature conditions please consult manufacturer at 1-800 426-9341 and ask for the Transmate Division.

4. Position the drive adapters threaded rod so that it will pass over the serial number plate section on the brake tube. This will allow the adapter to fit over the square of the shaft.

Manually rotate the shaft by turning the cutter to align the shaft and adapter together.

Tighten down the Drive Adapter Clamp Knob Assembly.

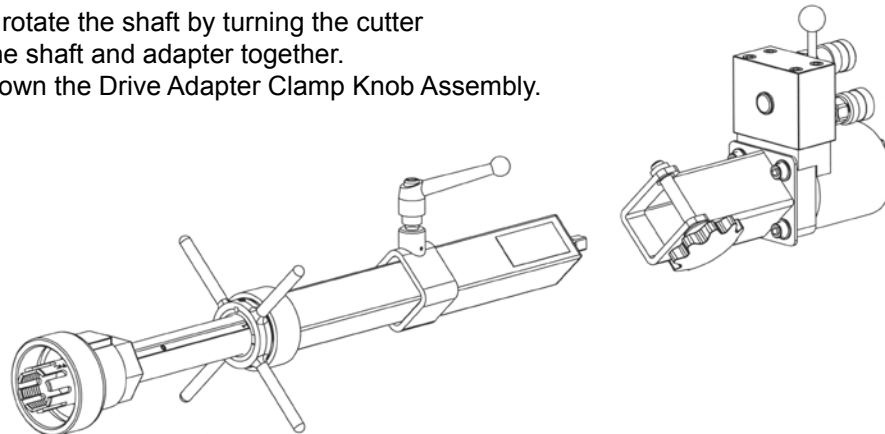

5. Ensure that the TapMate Too is positioned on the corporation stop as instructed in the TapMate Too manual and that all connections are tight.

Failure to make sure the connections are tight could result in the drive loosening up the connections.



6. **IMPORTANT:** The hoses have to be hooked up before the power unit is started.

Hook up hydraulic hoses from the pump to the drive. With the male and female quick disconnects on this unit's components, there is only one way to connect everything up.

If you are making a connection to your own hydraulic power source, you must connect the hydraulic flow "IN" and hydraulic flow "OUT" hoses correctly.

Please note that the shaft on the drilling machine should turn clockwise when viewed from the back of the drilling machine. If it does not, you need to switch the hoses.

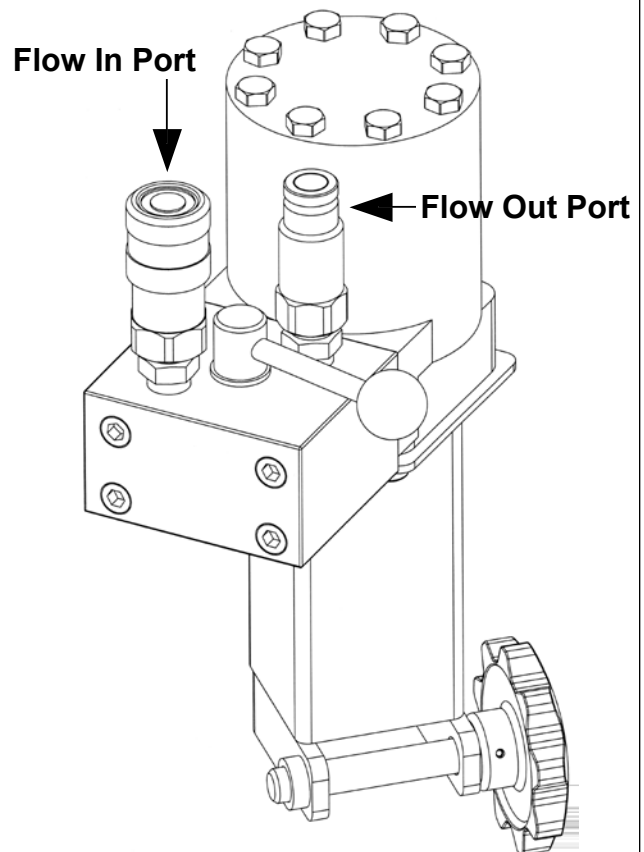

7. Position the hydraulic valve knob so that it points towards the motor. This will bypass the motor and keep it from turning.

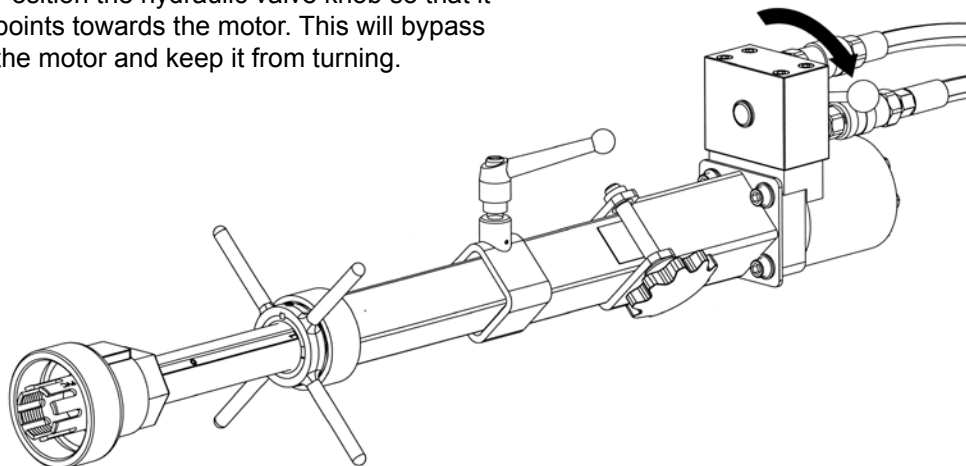

8. Move the fuel valve lever to the "ON" position.

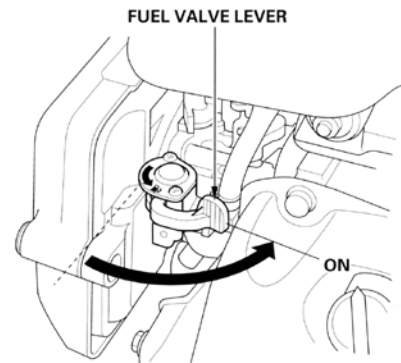

9. To start a cold engine, move the choke lever to the "CLOSED" position.
- To restart a warm engine, leave the choke lever in the "OPEN" position.

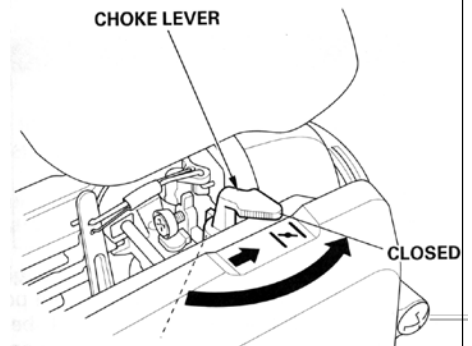

10. Turn the ignition switch to the "ON" position.

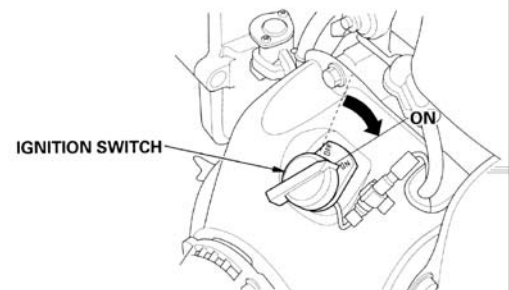

11. Pull the starter grip lightly until you feel resistance, then pull briskly. Return the starter grip gently.

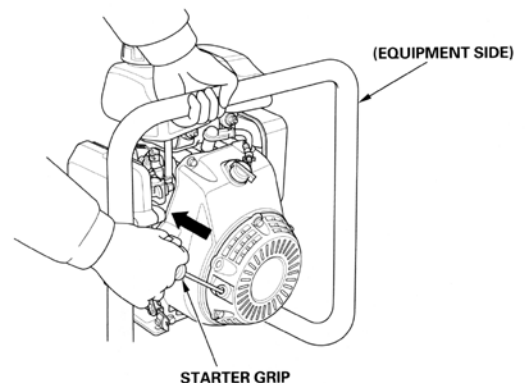

12. If the choke lever has been moved to the "CLOSED" position to start the engine, gradually move it to the "OPEN" position as the engine warms up. Let the power unit warm up for 1-2 minutes.

13. Position the hydraulic valve knob so that it points away from the motor. This will start the motor turning.

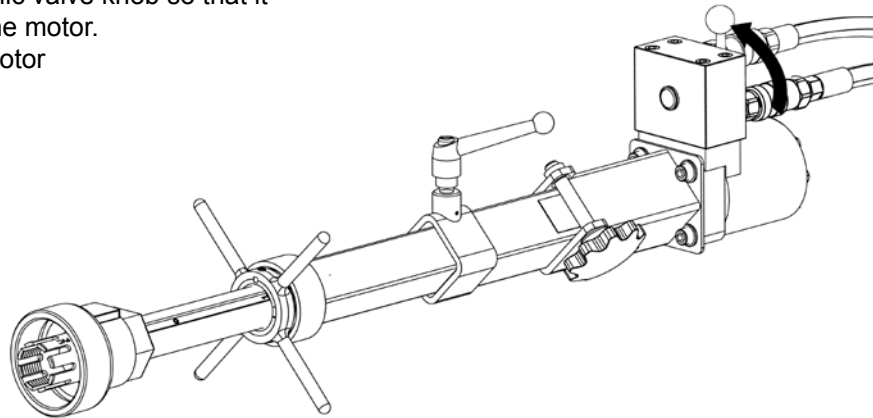

Using the Power Drive

Do not overfeed the drilling machine. It's much easier to overfeed the holesaws with this power drive as compared to hand operation.

Indications of over feeding the drilling machine are:

1. Gasoline engine slows down
2. Drive motor and holesaw stops rotating
3. Machine binds up and is hard to feed

Stopping the Power Drive:

1. Position the hydraulic valve knob so that it's next to the motor. This stops the motor by diverting the hydraulic fluid to by pass the motor.
2. Loosen the Drive adapter clamp knob and remove the Drive motor assembly from the Tapmate Too machine.

3. Move the throttle lever on the engine to the SLOW position. Let idle for 15-20 seconds.

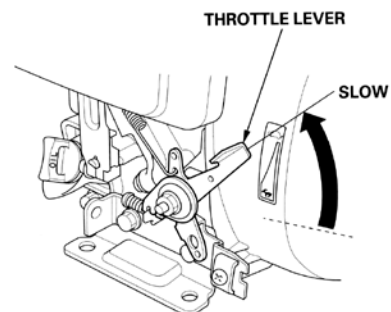

4. Turn the ignition switch to the OFF position.

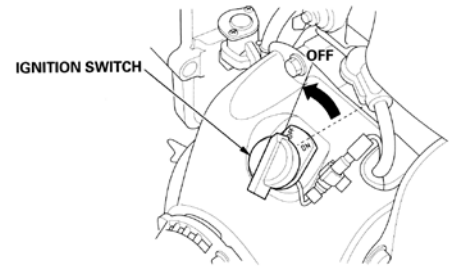

5. Turn the fuel valve lever to the OFF position.
6. Allow the unit to set for a minute before disconnecting the hydraulic hoses. This gives the fluid in the hoses time to depressurize.

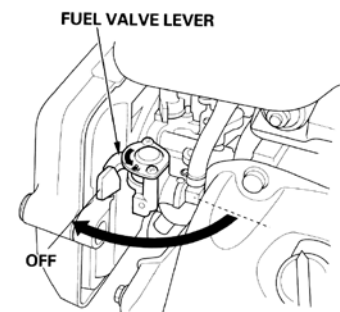

Fitting the Power Drive to your current TapMate Too

If this is a retrofit to your existing Tapmate Too machine, please continue on with this section. In some cases modification of the brake tube and or shaft on your existing TapMate Too will be needed. Please follow these instruction to see if modifications well be required (Refer to the drawing on Page 4 to help identify the parts referred to in the following section).

1. Take the hydraulic drive motor assembly and make sure that they fit over the back end of the brake tube of your TapMate Too. Position the drive adapter clamp knob assembly to slide over the serial number plate side of the brake tube. They should slide smoothly over each other. If not then weld material or high spots on the brake tube are keeping them from sliding. Grind or file down the high spots until they do.
2. Slide the hydraulic drive motor assembly down the brake tube until the hydraulic motor coupling engages the square end of the shaft. If the hydraulic motor coupling does not engage the shaft, rotate the other end of the shaft until it does. If it still does not fit, check the square end of the shaft. If it is mushroomed out, file the square end of the shaft back to a 1/2" square.
3. Make sure the drive adapter and motor coupling engage the drilling machine smoothly before going to the job site. If you have any questions please call 1-800-426-9341 and ask for the Transmate Division.

Common Problems:

<u>Symptom</u>	<u>Solution</u>
Hydraulic fluid milky colored	Water in hydraulic fluid - change hydraulic oil <u>immediately</u> .
Engine won't start	Check gasoline, oil level, spark plug, refer to engine owners manual
Hydraulic motor running erratically	Hydraulic oil low - fill to recommended level immediately

Other problems...

Call us, we want to help.
Dial **1-800-426-9341**, and ask for Transmate.

372-351-05-05 HD 1/4 IN. HOSE KIT

- 372-02-03HD Hydraulic Hose 1/4 x 20 ft. w ith 3/8 NPT Fittings..... Qty. 2
- 372-13-2HD Quick Disconnect, Male 3/8 Flush Face Qty. 2
- 372-02-03HD Quick Disconnect, Female 3/8 Flush Face Qty. 2

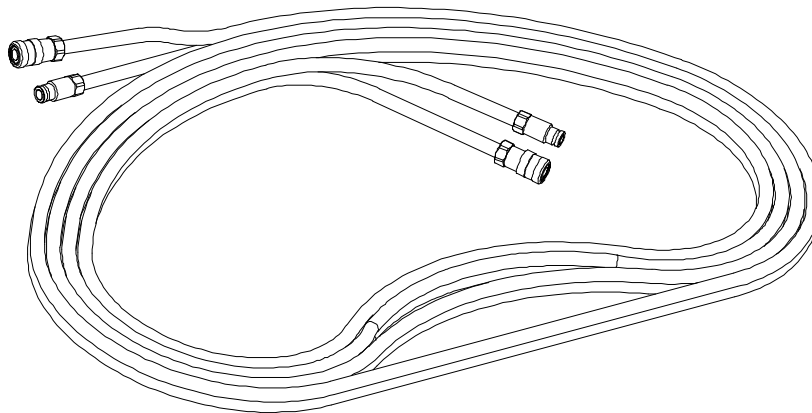

HD TAPMATE TOO HYDRAULIC DRIVE MOTOR ASSY AND BY PASS VALVE ASSEMBLY. 372-351-05-01

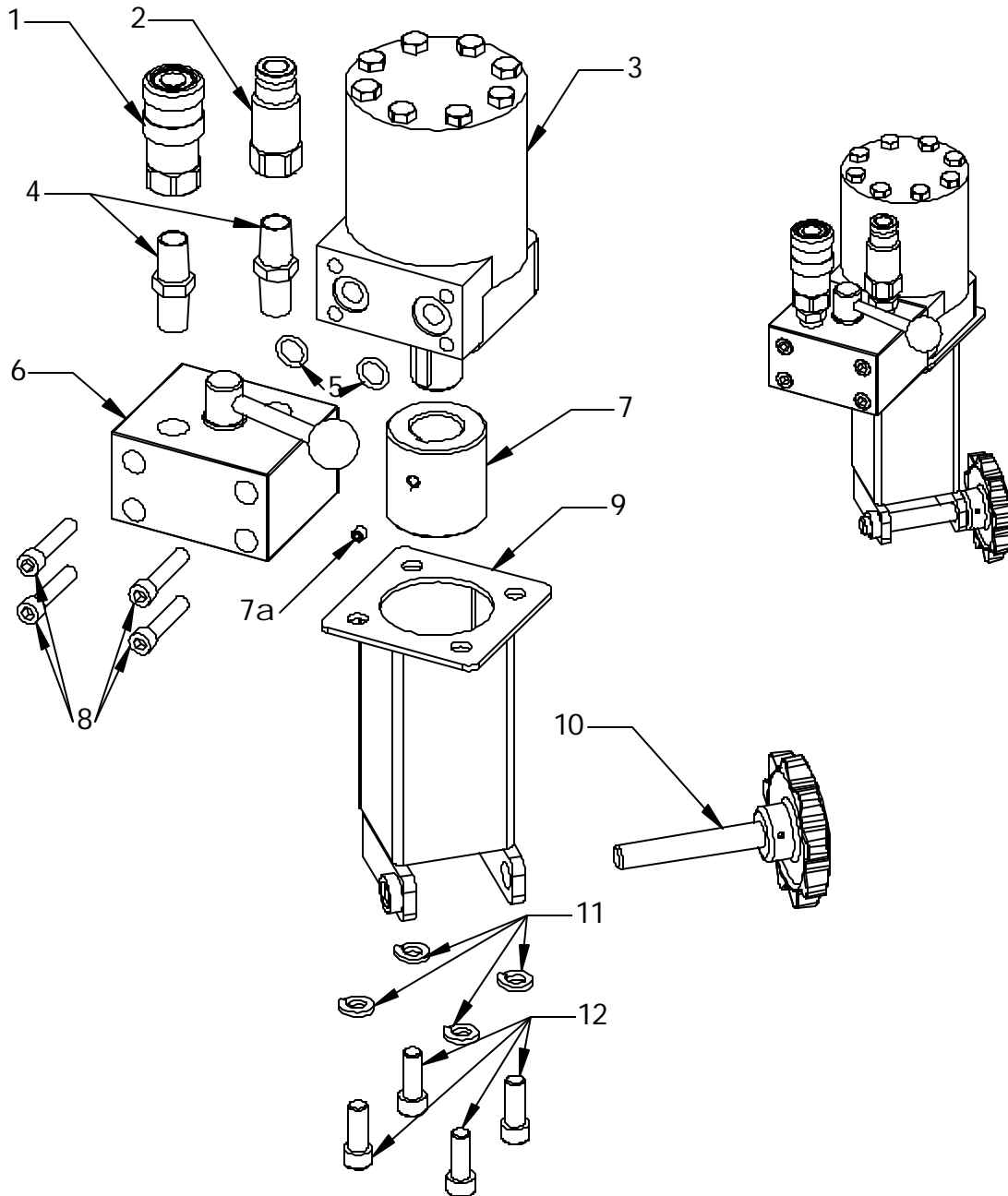

- | | | |
|------|------------|---|
| 1) | 372-13-3 | HD QUICK DISCONNECT,FEMALE 3/8" FLUSH FACE |
| 2) | 372-13-2 | HD QUICK DISCONNECT,MALE 3/8" FLUSH FACE |
| 3) | 372-351-12 | HD HYDRAULIC MOTOR ONLY TB0065FM100AAAB |
| 4) | 372-13-11 | HD 3/8" x 3/8" NPT HYD. NIPPLE |
| 5)** | 372-351-15 | HD HYDRAULIC MOTOR O-RING, 2-112 O-RINGS |
| 6) | 372-04 | HD BY PASS VALVE ONLY W/ BOLTS |
| 7) | 372-351-81 | HD TT HYDRAULIC MOTOR COUPLING |
| 7a) | 351-51-2 | TT,ARBORS & HANDLE SET SCREW,1/4"-20 1/4" S.H.S.S. |
| 8)** | 372-351-14 | HD HYDRAULIC VALVE BOLT, 5/16"-18 x 3 1/4" Lg. SHCS |
| 9) | 372-351-80 | HD DRIVE ADAPTER |
| 10) | 372-351-18 | HD DRIVE ADAPTER CLAMP KNOB ASSEMBLY |
| 11) | 372-07 | HD HYDRAULIC LOCK WASHER 3/8" |
| 12) | 377-12-01 | SM,MOTOR BOLT 3/8"-16 x 1" SHCS |

** ARE INCLUDED IN 372-04 HD BY PASS VALVE ONLY W/ BOLTS AND O-RINGS